

Wulian[®]

ISO9001:2008 Certified

Smart Water Leakage Sensor

WL-ZSSMBPW-FD-02

User Manual



©2016 Nanjing IOT Sensor Technology Co., Ltd.

Publication Number: 2016-0728.V01

Welcome to Use Wulian Smart Water Leakage Sensor

- **Wulian** is the registered trademark of Nanjing IOT Sensor Technology Co., Ltd. All the other product names or trademarks mentioned in the manual belong to the trademarks or registered trademarks of the respective possessors.
- Please read this manual carefully to ensure proper and safe use.
- Wulian Smart Water Leakage Sensor (hereinafter referred as “this product”) is manufactured by Nanjing IOT Sensor Technology Co., Ltd. (hereinafter referred as “Wulian”) as a product in the category of security. This product shall be used with supplied accessories. Wulian is not responsible for any loss due to improper installation or usage of this product.
- Wulian will update product information in this manual anytime without prior notice. Please pay attention to our information timely.
- Without specific written permission from our company, no individuals or companies can copy the content or part of the content in this manual, or use the registered trademark of our company. We will investigate for the legal responsibility of individuals or companies for illegal use of our trademark.
- Welcome to visit Wulian official website www.wuliangroup.com for more information.

Product Illustration

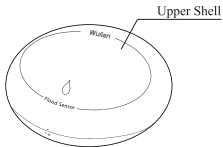

Front

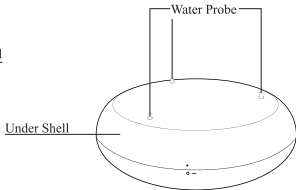

Back

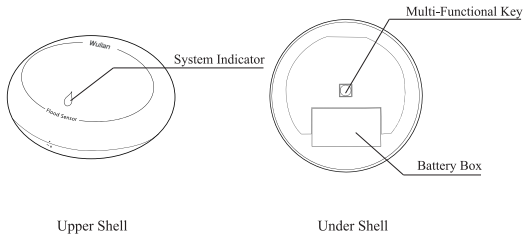

Features

- It can monitor water leakage effectively.
- Remote monitor by any smart mobile terminals.
- The high-sensitive water probe can monitor water leakage and send alarm notifications immediately.
- It can work together with other smart devices through group linkage, such as Smart Automatic Manipulator.

Product Size

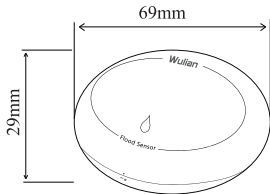

Installation & Networking

1. Put a CR2 battery in battery box.

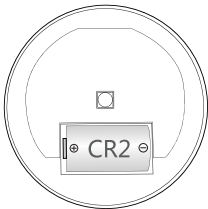

2. Before setting, please make sure the gateway (needs to be purchased) works normally and the ZigBee network indicator flashes, also the product is in a power-on state and within valid communication scope of the wireless gateway.
3. Before operating, please make sure the product is not connected to any other gateway; or exit the connecting ZigBee network before networking again (new product can be connected to the network directly).

Note: This product is applied to HA1.2 wireless gateway only.

4. Networking

4-1. First time to join the network

- Allow the gateway for networking (refer to the gateway manual for details);
- When use the product for the first time, power it on and it will apply to join the ZigBee network automatically;
- Then the [System Indicator] flashes while searching for the network;
- When successfully joins the ZigBee network, the [System Indicator] stays on for 2 seconds and then goes out.



- ① [System Indicator] flashes while searching for the network
- ② When successfully joins the ZigBee network, the [System Indicator] stays on for 2s and then goes out

4-2. Join the network manually

- If the device needs to join the ZigBee network again after exiting it, quick click [Multi-Functional Key] once, then the [System Indicator] flashes while searching for the network;
- When successfully joins the ZigBee network, the [System Indicator] stays on for 2 seconds and then goes out.

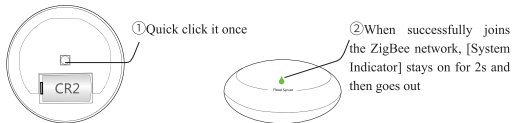

Note: Quick click the [Multi-Functional Key] once and [System Indicator] flashes once to indicate successful networking.

5. Exiting the Network

- Long press the [Multi-Functional Key] for 6s and loose it;
- Then the [System Indicator] flashes 4 times regularly and goes out to exit the current ZigBee network.



Note:

If the device cannot join the ZigBee network after the operations above, please follow the following steps (please make sure the gateway is allowed for networking): ①exit the network (refer to Exit Setting for details); ②wait for 2s and quick click [Multi-Functional Key] once to join the network.

6. Align the setting circle of under shell and setting dot of upper shell, tighten the upper shell when turning it clockwise to align fixed point with fixed line.

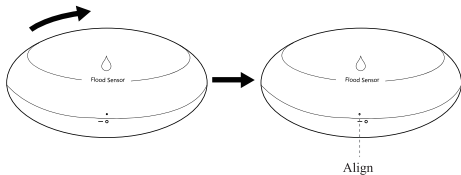

User Guide

When this product detects water leakage, it will send alarm notifications immediately to mobile smart terminals. Meanwhile, [System Indicator] flashes red. This product will automatically eliminate the police after it is taken out of the conductive liquid.

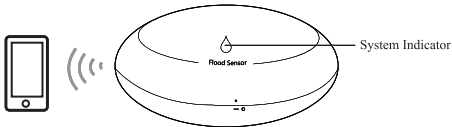

When the battery voltage level is too low, mobile smart terminals will receive undervoltage alarm notifications to remind users to change batteries in case of not affect the normal use.



Cautions

- Make sure this product is placed on fixed flat surface, in case of poor effect on detection.
- Do not place this product wholly into water or other conductive liquid, in case of poor effect in use by being exposed to moisture.
- Do not drop this product high in the air or smash it in case of affecting the service life.
- When the product surface is stained with dust, please clean it by dry cloth; it is forbidden to clean it by corrosive cleaning fluid or chemical solvent.
- This product shall be inspected regularly for malfunction to ensure timely alarm.
- Please do not disassemble or refit this product or its accessories.
- If the product breaks down, please send it to local service center for repair or contact our customer service staff. Non-professionals cannot handle it personally.



Please replace the battery with the correct model, so as to avoid the danger of explosion! Please deal with the waste battery according to the operating instructions!

Electrical Parameter

Communication Mode	IEEE 802.15.4 (ZigBee/HA1.2)
Antenna Type	Internal Antenna
Power Parameter	DC 3V
Standby Current	$\leq 2\mu\text{A}$
Power Supply	CR2*1
Water Level	$\geq 1\text{mm}$

Structure Parameter

Panel Size (Diameter*Thickness)	Φ69x29mm
Material & Color	PC, White
Flame Retardant Rating	UL94 V-2
Working Temperature	-10℃~+45℃
Working Humidity	≤95%RH (Noncondensing)
Mounting Type	Mobile
Net Weight (g)	47g
Storage Temperature	-20℃~+60℃

Purchasing Information

Name	Model
Smart Water Leakage Sensor	WL-ZSSMBPW-FD-02

No. 15, Fengji Road, Yuhuatai District, Nanjing, Jiangsu Province, China

Email: overseas@wuliangroup.com

Service Line: +86-400 889 2891

Official Website: www.wuliangroup.com