

Wulian[®]

ISO9001:2008 Certified

Smart Panic Button

User Manual

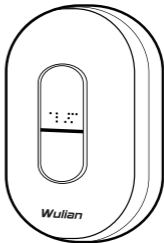

©2016Nanjing IOT Sensor Technology Co., Ltd.
Publication Number: 2016-0801.V01

Welcome to Use Wulian Smart Panic Button

- **Wulian** is the registered trademark of Nanjing IOT Sensor Technology Co., Ltd. All the other product names or trademarks mentioned in the manual belong to the trademarks or registered trademarks of the respective possessors.
- Please read this manual carefully to ensure proper and safe use.
- Wulian Smart Panic Button (hereinafter referred as “this product”) is manufactured by Nanjing IOT Sensor Technology Co., Ltd. (hereinafter referred as “Wulian”) as a product in the category of controlling. This product shall be used with Smart Home App as well as supplied accessories. Wulian is not responsible for any loss due to improper installation or usage of this product.
- Wulian will update product information in this manual anytime without prior notice. Please pay attention to our information timely and download Smart Home App with the latest edition.
- Without specific written permission from our company, no individuals or companies can copy the content or part of the content in this manual, or use the registered trademark of our company. We will investigate for the legal responsibility of individuals or companies for illegal use of our trademark.
- Welcome to visit Wulian official website www.wuliangroup.com for more information.

Product Illustration



Roof Cover

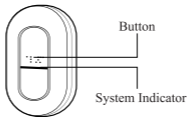

Main Body



Bottom Cover

Front Side

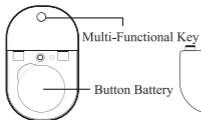

Smart Panic Button

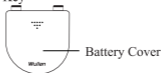

Back Side



Bottom Cover

Features

- Support emergency alarm feature, push alert message to smart home App at first time and link with Smart Sound Warner to alarm.
- Low power consumption, small size, no wiring, easy operation and portable.

Software Download

Option A:

Download the latest Smart Home App by scanning the QR code on the package box of this product.

Option B:

iOS user can download the App by searching "Wulian Smart Home" in "App Store".

Android user can download the App by searching "Wulian Smart Home" in "Google Play".

Warm prompt: For the first use, please download Smart Home App and read user manual carefully. Please pay attention to Wulian information to download the latest App in time.

Installation Steps

Step One:

Open the battery cover on the back side; put a CR2450 battery; then close the battery cover.

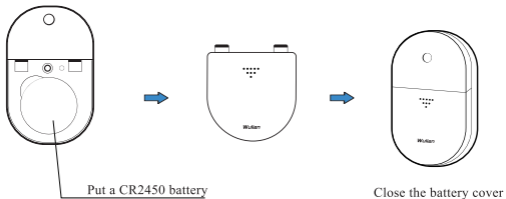

Step two:

Portable using: with a silicone ring, the product can be carried along and use with the Lanyard.



Wall mounted use:

Option 1: Stick the product on flat Wall Surface with the Foam Rubber. Stick the Foam Rubber to the Base and then paste the Base to the selected location.

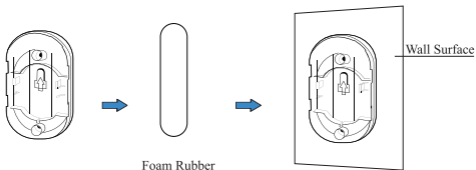

Note: Before installation, please keep the selected position smooth and tidy.

Option 2:

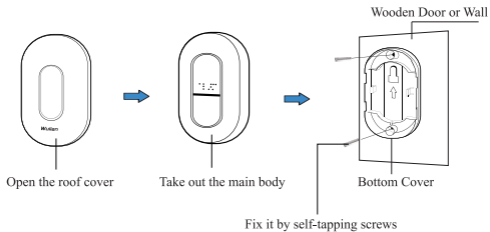

Network Setting

1. Before setting, please make sure the gateway (need to be purchased) works normally and the ZigBee network indicator flashes, also the product is in a power-on state and within valid communication scope of the wireless gateway.

2. Before operating, please make sure the product is not connected to any other gateway; or exit the connecting ZigBee network before networking again (new product can be connected to the network directly).

3. Network Setting

① First time to join the network

- Allow the gateway for networking (refer to the gateway manual for details);
- When use the product for the first time, power it on and it will apply to join the ZigBee network automatically;
- Then the [System Indicator] flashes while searching for the network;
- When successfully joins the ZigBee network, the [System Indicator] stays on for 2 seconds and then goes out.

② Join the network manually

- Hold down the [Button] and quick click [Multi-Functional Key] once, then the [System Indicator] flashes while searching for the network;
- When successfully joins the ZigBee network, the [System Indicator] stays on for 2 seconds and then goes out.

Note: Holding down the [Button] and quick click the [Multi-Functional Key] one time, [System Indicator] flashes once to indicate successful networking.

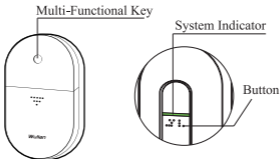

4. Exit the Network

- Hold down the [Button] and quick click the [Multi-Functional Key] 8 times (with each click within 1s);
- Then the [System Indicator] flashes 4 times regularly and goes out to exit the current ZigBee network.

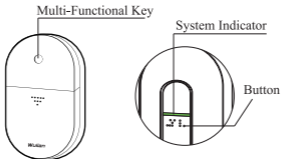

Note 1:

If the device cannot join the ZigBee network after the operations above, please follow the following steps (please make sure the gateway is allowed for networking): ①exit the network (refer to Exit Setting for details); ②after waiting for 2s, hold down the [Button] and quick click [Multi-Functional Key] once to join the network.

Note 2:

After exiting the network, please do not cut off the power (such as switching off the power, removing the battery, etc.) within 4s in case of device abnormality.

User Guide

- Log into the Smart Home App to add the device.
- Arm or disarm the device in the App (sending alarm message to smart phone when emergency happens).

Cautions

- Please install the battery before using the product. The battery inside product package is recommended.
- This product should be put in dry and clean place to prevent inner component from dampness or other debris.
- When the product surface is stained with dust, please clean it by dry cloth; It is forbidden to clean it by corrosive cleaning fluid or chemical solvent.
- Please do not disassemble or refit this product or its accessories.
- If the product breaks down, please send it to local service center for repair or contact our customer service staff. Non-professionals cannot handle it personally.

Electrical Parameter

Communication Protocol	IEEE 802.15.4 (ZigBee/ SmartRoom)
Antenna Type	Internal Antenna
Power Parameter	DC 3V
Power Supply	CR2450*1
Standby Current	$\leq 0.5\mu\text{A}$

Structure Parameter

Overall Dimension (Length*Width*Height)	92×54×20(mm), 63×37×15.5(mm)
Material & Color	PC+ABS ,White
Installation Method	Wall-mounted, portable
Net Weight	50(g)
Flame Retardant Rating	UL94 V-2
Working Temperature	-10°C ~ +45°C
Working Humidity	≤95%RH(Noncondensing)

Purchasing Information

Product Name	Smart Panic Button
Model	WL-ZSPPBPW-IB-03
Material & Color	PC+ABS, White

No. 15, Fengji Road, Yuhuatai District, Nanjing, Jiangsu Province, China

Email: overseas@wuliangroup.com

Service Line: +86-400 889 2891

Official Website: www.wuliangroup.com