



Weather-proof Camera (1080P)

Quick Start Guide

**Wulian**<sup>®</sup>



# Product Display

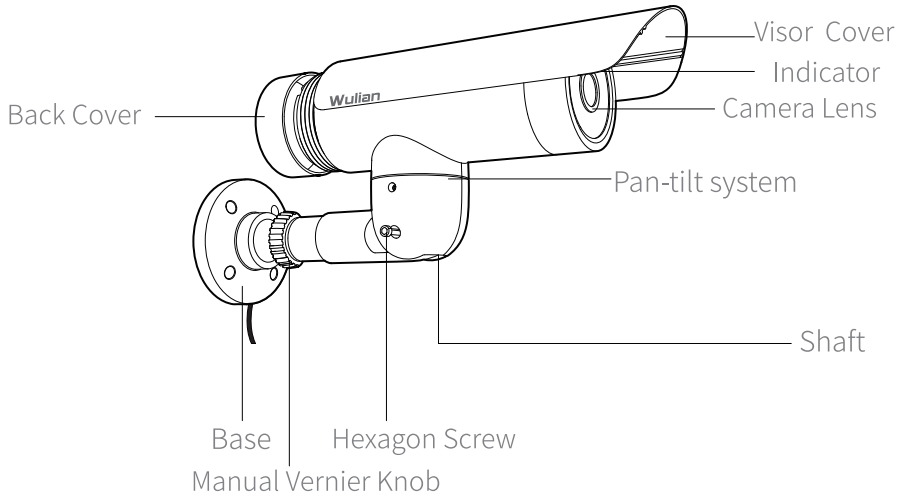

# Function



150 ° horizontal(Electric)  
85 ° Vertical(Manual)

Pan-tilt range



Support Wi-Fi and Wired  
connect mode

WiFi+Wired



1080P HD video recording

HD image



Video stored on card and  
replayed at any time

Storage/Replay



Support motion detection and  
alarm, pay attention to outdoor  
constantly

Motion detection



Support two-way voice  
communication

Audio intercom



Work well in both Day and Night

Day /Night conversion

# Power on

Connecting the device to power (power wire needs to be prepared by user), the indicator flashes quickly in green and the motor rotates to conduct a self-inspection. After start-up is completed, the indicator flashes slowly in green, waiting for network setting.

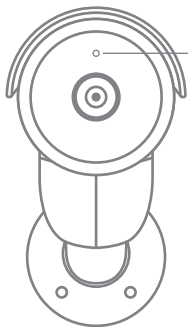

Indicator

Green: quick flash in green while start up; turn to slow flash in green when finish startup and wait for networking  
Red: slow flash in red while network connection fails.

# Network Setting

Download and install the "iCam"APP

1. Scan below QR code,download and install the "iCam"APP.



4

2. Open the "iCam"APP,register a new account or login in with existing account.

### 3.Add Camera

Login in the APP, and chooser “+” in upper right of the screen, follow APP guide, scanning the QR code of Device ID below(or inside the back cover), finish adding camera.(please make sure the camera connect with 2.4GHz Wi-Fi)

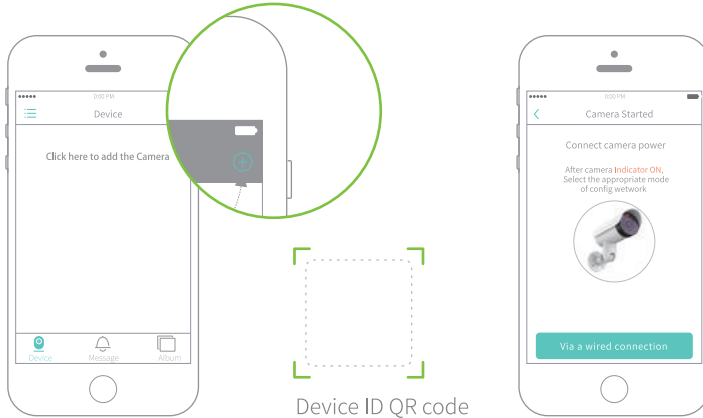

4. When camera add successfully,click the show list and check current video by APP.

6

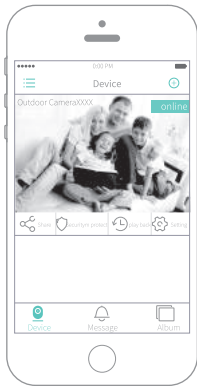

Note: Finish network setting then powered off to start installation.(power off does not affect the current network)



# Installation Guide

## Before Installation

1. For security, please do a good job of safety protection measures, it is not allowed to stand below the installation site to avoid the injury.
2. The install point (Wall or Ceiling) must be withstand more than 5 times the weight of the camera.
3. Please fix the four self tapping screws attached at the install point.
4. Make sure there's no cable breakage or cable peeling to avoid product damage and fire accident.
5. To avoid the electric shock, disassembling product is not allowed.
6. Place the product in flat surface and keep away from strong electromagnetic fields.
7. Do not pull or drag the wire harness.
8. The product is waterproof and conforms to the IP66 specification, but the interface to the external cable is not waterproof. Please follow the waterproof treatment during installation.

## Installation Step

Micro SD card installation diagram

8

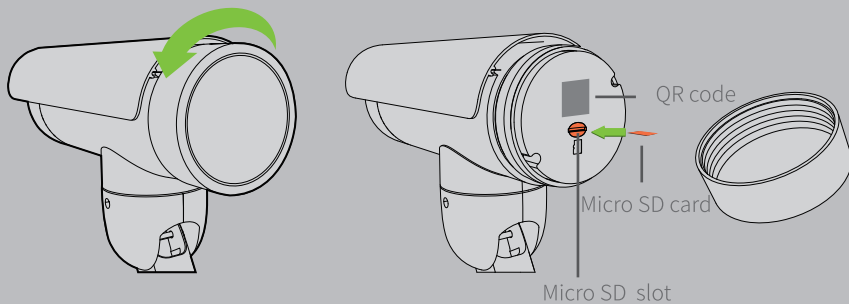

Note: Please follow the installation guide to put in the Micro SD card.

## Device installation diagram

This product supports pan and tilt by APP, the range is 150°horizontal(Electric) ,85°Vertical(Manual).

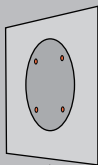

Fix position



Drilling

1. Choose the right install point , use the attached install locating card, mark the location hole of the base.

2. Use the electric drills(size  $\Phi 4\text{mm}$ ) to drill in the marked spots.

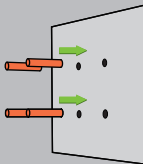

Expansion screws

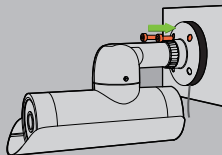

Upper screws

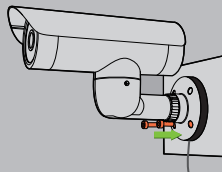

Bottom screws

3. Install the expansion plugs.

4. Align the base of camera with the expansion plug, use the self tapping screws fix them.

Note: To avoid interference from screws on the body, rotation angle can be adjusted first (show as top picture). Fasten the rotation, and fix two upper screws, then fix two bottom screws with same method.

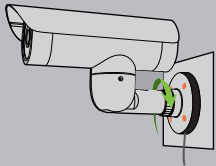

Fasten the knob

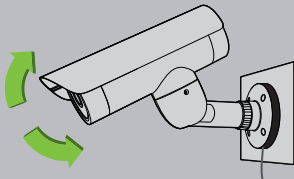

Adjust angle

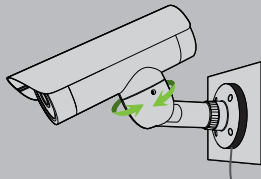

5. Fine tuning the body with manual knobs to fix the body position.

6. Use inner hexagon spanner to adjust the shaft (do not use hand to adjust the shaft forcibly), fine tuning the monitor angle to reach a best result, then fasten the shaft.

## Wire connection diagram

This product supports two power supply modes:

1. use the power adapter to power the equipment;
2. through the network port/POE port to power the camera while connecting network at the same time.

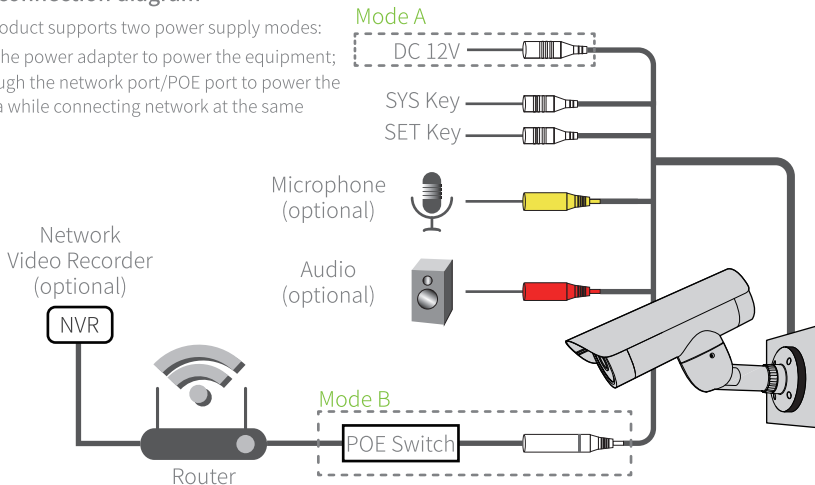

Note: To have a more stable network and get a better user experience, wire connection is recommended.

## Waterproof treatment diagram

Network interface waterproof treatment

This product's network port has waterproof design, please refer to the following steps for outdoor installation to avoid short circuit in water.

1. Cut off the crystal UTP from network cable which needs to be connected with the camera, and then pass the network cable through the waterproof cap and waterproof body.
2. Connect the crystal UTP with network cable. Then put the rubber gasket onto camera's network port.
3. Insert the network cable (with crystal UTP) into camera's network port, and fix the waterproof body onto network interface and then screw the waterproof cap clockwise.

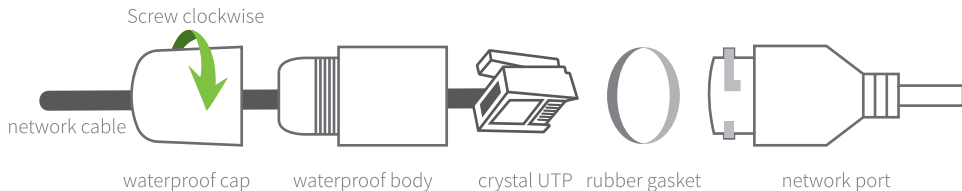

Note: In order to achieve a better waterproof effect, a layer of butyl tape can be wrapped around the waterproof body (see audio port/power port waterproof treatment).

## Audio / power port waterproof treatment diagram

This product's audio/power port don't have waterproof design, waterproof treatment must be done during installtion, please refer to the following steps:

1. Follow the installation to connect wire to the port.
2. Wrap black cable (zone A) with waterproof butyl tape and make sure more than half of butyl tape overlap with each other.

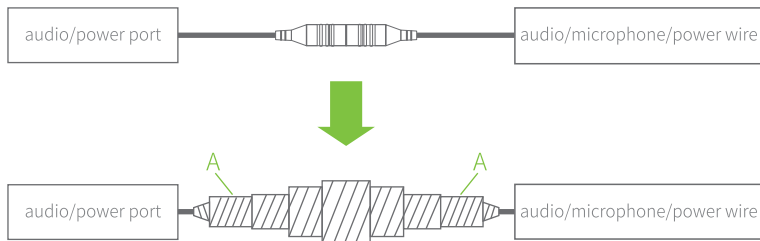

Note: If the cable is not properly protected with waterproof treatment, it may directly lead to device damage by water leakage. The waterproof butyl tape is made by butyl rubber and can be stretched to twice times the normal length.



# Product Parameter

Product Name:	Wulian Weather-proof Camera(1080P)
Product Model:	WL-ZAWDMW-C221121-01
Power Supply:	12V---2A/PoE 12V---1.25A
Net Weight:	2.2KG
Dimensions: (L*H*W):	368mm*268mm*120mm
Image Sensor:	1/2.9" CMOS image component
Resolution:	Max1920x1080
Rotation Angle:	Horizontal 150° (Electric) ,Vertical 85° (Manual)
Night Vision Distance:	10~50m
Storage:	Max 128G Micro SD
ONVIF:	support
Communication protocol:	IEEE 802.11b/g/n, IEEE 802.15.4, IEEE 802.3af
Operating Temperature:	-20~60°C
Operating Humidity:	≤95% ( No condensation)
Flame Retardant Rating:	UL94-V2
Protection Rating:	IP66





Official Website: [www.wuliangroup.com](http://www.wuliangroup.com)

Service Line: +86-400 889 2891

Email: [overseas@wuliangroup.com](mailto:overseas@wuliangroup.com)

Address: No. 15, Fengji Road, Yuhuatai District, Nanjing, Jiangsu Province, China